



Batch Plant Service, LLC

San Antonio, TX 78232
(210) 262-9509

www.BPSTX.com
info@bpstx.com

Maintenance - Instructions

for Valve Repair Kit – BPS 17-0152
for High Pressure Pump – Model 25/41
from “Walter Geraetebau – Germany”

Instructions for Valve Repair Kit for the High Pressure Pump - Model 25/41 from "Walter Geraetebau - Germany"

Kit # BPS 17-0152

Item#	Part#	Description	Qty.
27A	08408	Valve Assembly	6
33	07214	O-Ring	6

* Marked parts are included in the kit

NOTE: Always take time to lubricate all metal and nonmetal parts with a light film of oil before reassembly. This step will ensure proper fit, and at the same time protecting the pumps nonmetal parts (elastomers) from cutting and scoring.

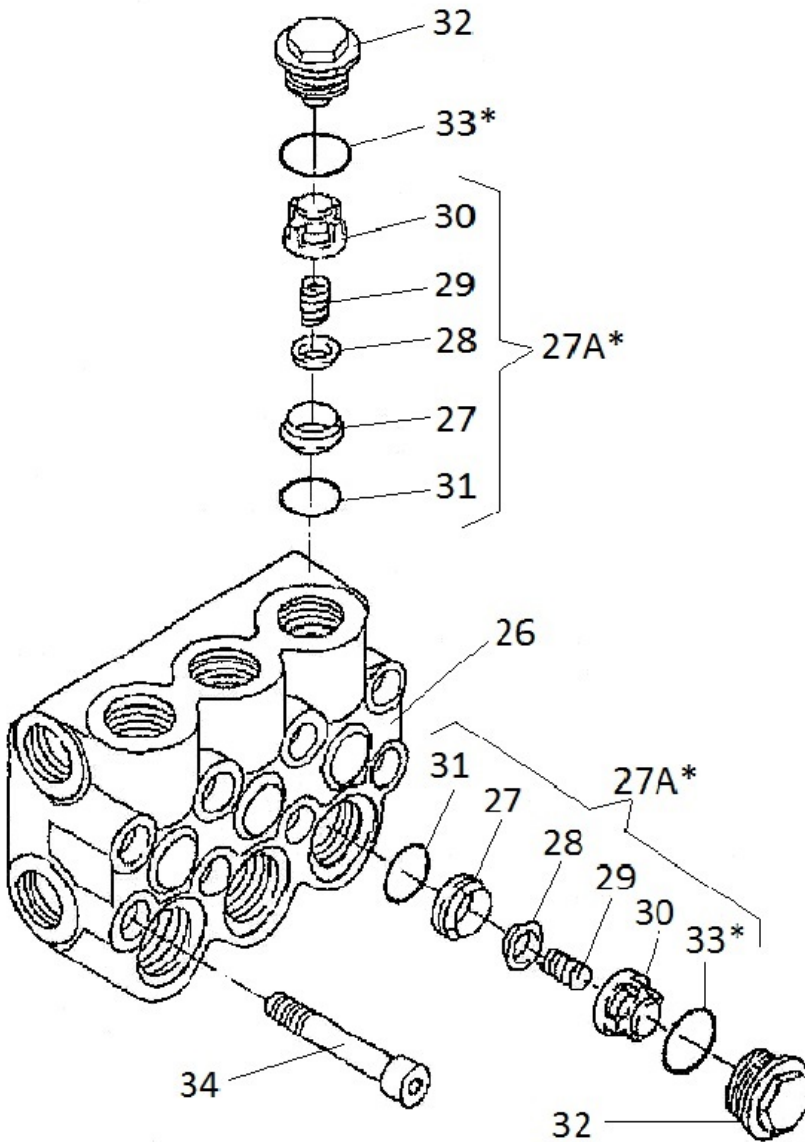

Repair Instructions

- 1) With a socket wrench, remove the six valve plugs (32) from the valve casing (26). Remove the o-rings (33) from the plug, clean the plug and install new o-ring from the kit.
- 2) Using a needle nose plier, remove the inlet and discharge valve assemblies (27A) from the valve casing (26). Make sure the o-rings (31) are also removed.
- 3) Place new o-ring (31) on each valve seat (27), if not already done and place the completed assembly back into the valve casing (26).
- 4) Replace each valve plug (32) and tighten valve plugs to the valve casing (26) to 107 lb-ft (145 Nm).